

DETAIL 4A  
"OVERLAP"

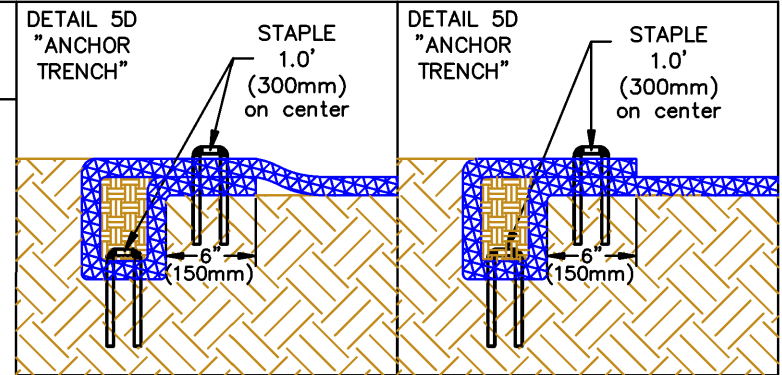

DETAIL 5D  
"ANCHOR TRENCH"

STAPLE  
1.0'  
(300mm)  
on center

DETAIL 5D  
"ANCHOR TRENCH"

STAPLE  
1.0'  
(300mm)  
on center

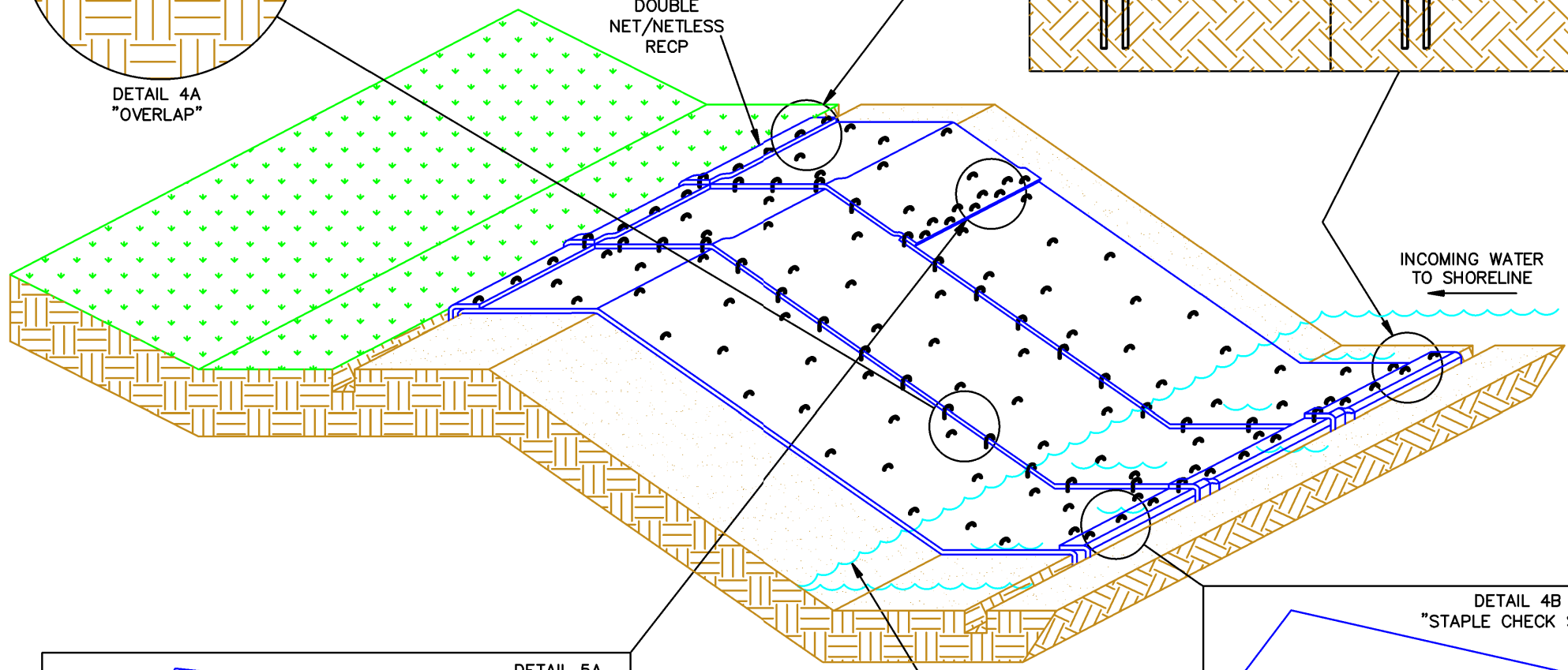

DOUBLE  
NET/NETLESS  
RECP

INCOMING WATER  
TO SHORELINE

NORMAL  
WATERLINE

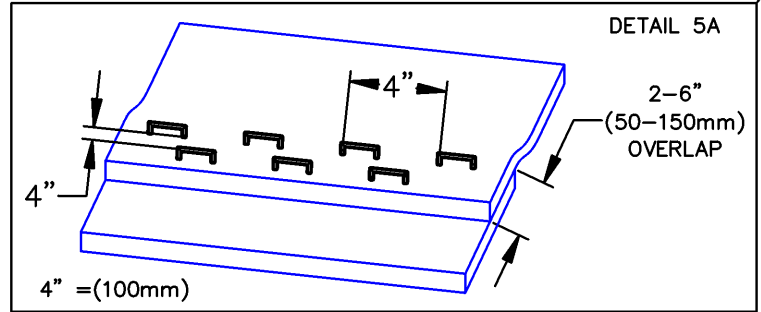

DETAIL 5A

2-6"  
(50-150mm)  
OVERLAP

4" = (100mm)

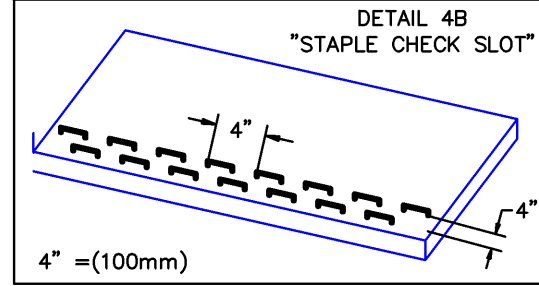

DETAIL 4B  
"STAPLE CHECK SLOT"

4" = (100mm)

HEET DESCRIPTION	SHORELINE DRAWING #5 Erosion Control Technology Council – Denver, CO.	
PROJECT No.	RECP SHORELINE INSTALLATION	
PROJECT MANAGE:	SCALE:	NONE
CHECKED BY:	DRAWING REVISION DATE:	07/22/2020
APPROVED BY:	VERSION NUMBER:	



For further information please refer to ECTC Installation Guidelines

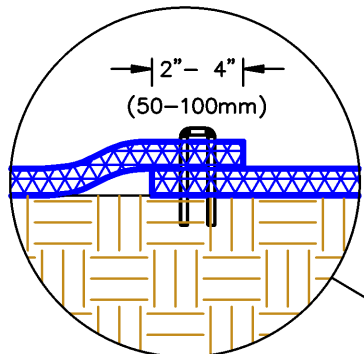

DETAIL 4A  
"OVERLAP"

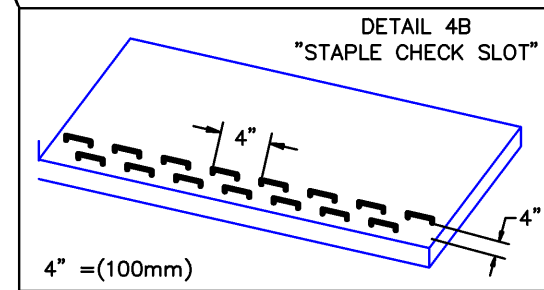
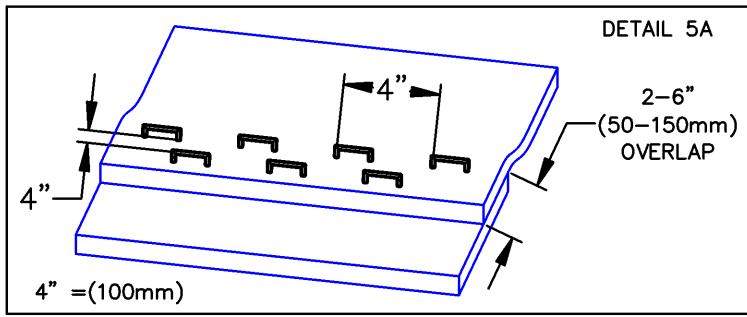
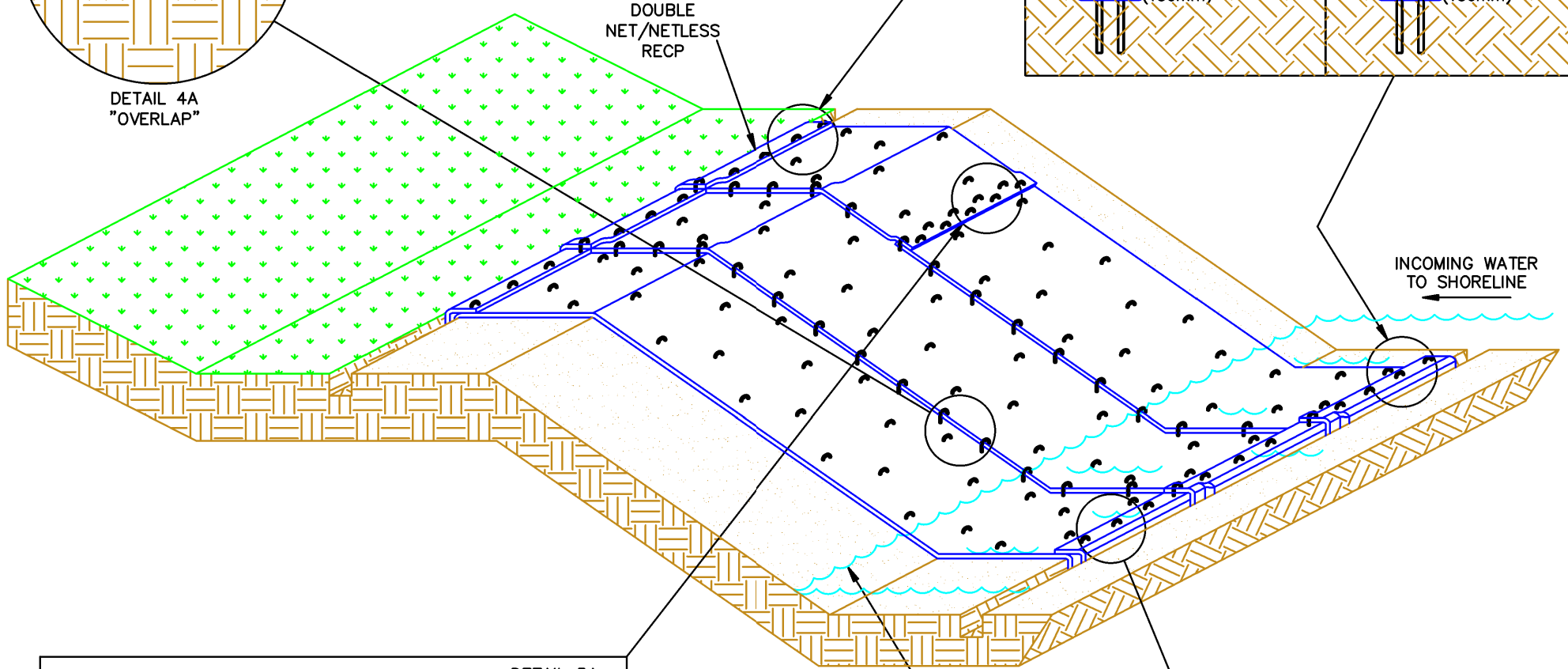
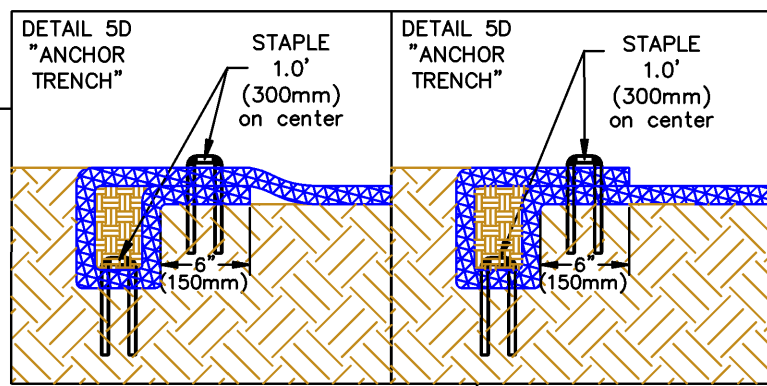

For further information please refer to  
ECTC Installation Guidelines